

REPLACEMENT PARTS SUITABLE FOR ESAB®/L-TEC®

PT-26™

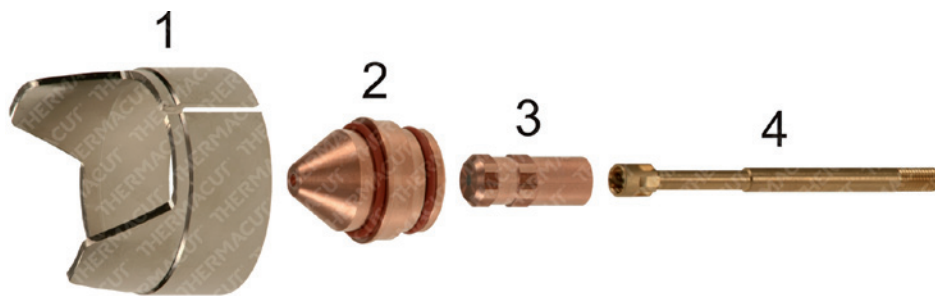

Item	Part No.	Ref. No.	Description	Std. Pkg.	Item	Part No.	Ref. No.	Description	Std. Pkg.
1.	T-2328	36648	Stand-off Guide	1	3.	T-8997	36565	Electrode Air, N ₂ , N ₂ /H ₂	5
2.	T-2331	36568	Nozzle 150Amp	5		T-2337	36566	Electrode Ar/H ₂	5
	T-2333	36570	Nozzle 300Amp	5	4.	T-2339	34585	Baffle Tube	1
	T-2334	36571	Gouging Nozzle 200Amp	5	NS	T-2338	34593	Insulator	1

PT-27™

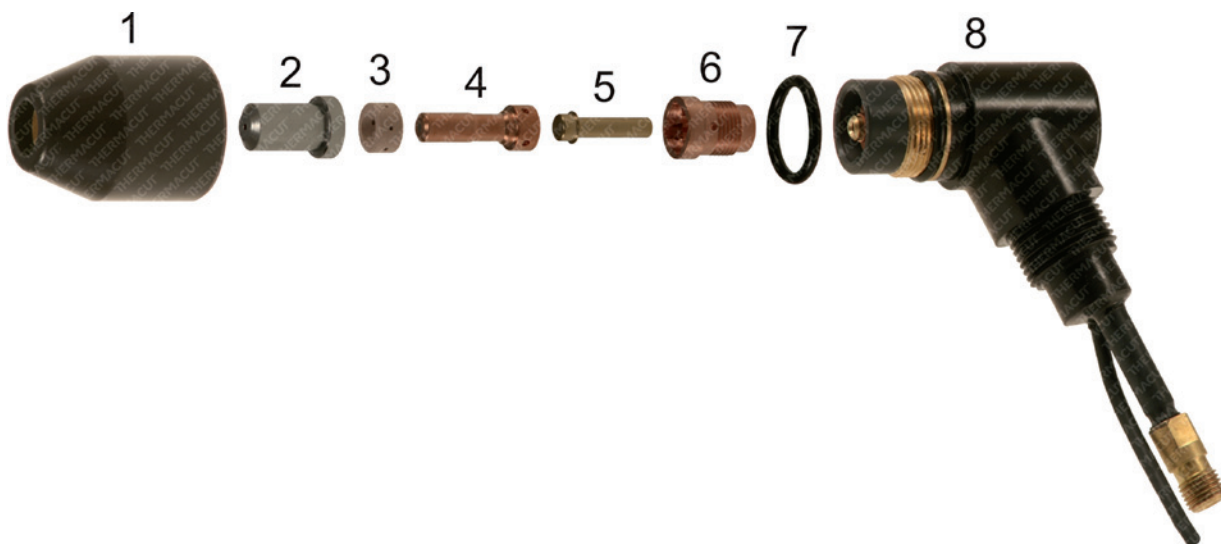

Item	Part No.	Ref. No.	Description	Std. Pkg.	Item	Part No.	Ref. No.	Description	Std. Pkg.
1.	T-1307	21616	Heat Shield	1	6.	T-1310	21615	Replaceable Seat	5
2.	T-1260	33368	Nozzle 0,9mm 30A	10	7.	T-1306	85W51	O-Ring	1
	T-1261	33369	Nozzle 1,2mm 50-70A	10	8.	T-1309	21610	Torch Body 70°	1
	T-1262	33418	Nozzle 1,3mm 80A	10	NS	T-1986	21420	Stand-off Guide	1
	T-0057	35442	Gouging Nozzle 2,4mm	10	NS	PT-10220	0558003032	Seat Assembly	1
3.	T-1263	33367	Swirl Baffle	5	NS	T-3953	0558003027	Seat Instalation Tool	1
4.	T-1264	33366	Electrode	10	NS	KT-1301	21620	PT-27™ Cable Leads, 7,6m (25')	1
5.	T-1308	21619	Valve Pin	5					

NS NOT SHOWN IN THE PICTURE

Last update of this page: 02/10/2016. See Revision history for details.

THERMACUT
THE CUTTING COMPANY

WWW.THERMACUT.CZ
TEL.: +420 556 423 418
SALES@THERMACUT.CZ

WWW.THERMACUT.DE
TEL.: +49 (0) 27 39 40 33 0
INFO@THERMACUT.DE

WWW.THERMACUT.COM
TEL.: 1-603-542-6715
CUSTOMERSERVICE@THERMACUT.COM

THERMACUT®, FHT-EX® AND EX-TRAFIRE® ARE REGISTERED TRADEMARKS OF THERMACUT S. R. O. AND MAY BE REGISTERED IN CZECH REPUBLIC AND/OR OTHER COUNTRIES. ALL OTHER TRADEMARKS ARE PROPERTIES OF THEIR RESPECTIVE OWNERS. THERMACUT IS NO WAY AFFILIATED WITH ESAB®/L-TEC®. MOST THERMACUT PARTS ARE MADE FOR OR BY AN IBG COMPANY. PARTS INDICATED WITH A OEM ARE ORIGINAL PARTS MANUFACTURED BY THE ABOVE NAMED MANUFACTURER AND ARE BEING RESOLD BY THERMACUT. THERMACUT RESERVES THE RIGHT TO SUBSTITUTE OEM PARTS IN PLACE OF THERMACUT PARTS. VALID FROM OCTOBER 2016 • PREVIOUS VERSION IS NO LONGER VALID. • © COPYRIGHT 2016 BY THERMACUT® CZECH REPUBLIC. ALL RIGHTS RESERVED.